



Welcome



3084TH AVIATION DEPOT GROUP (AMC)  
Stony Brook Air Force Station  
Chicopee Falls, Massachusetts

# I N D E X

| TITLE                                   | PAGE |
|---|------|
| Commander's Welcome                     | 1    |
| Guide for Newly Assigned Personnel      | 2    |
| General Information                     | 3    |
| Reporting In                            | 3    |
| Identification                          | 3    |
| Automobile Registration                 | 3    |
| Camera and Private Firearm Registration | 4    |
| Security                                | 4    |
| Visits by Dependents and Guests         | 4    |
| Sick Call                               | 4    |
| Housing Facilities                      | 5    |
| Bachelor Quarters                       | 5    |
| Family Housing                          | 5    |
| Stony Brook Club Activities             | 6    |
| Officers' Club                          | 6    |
| NCO Open Mess                           | 6    |
| Service Club                            | 6    |
| Dining Facilities                       | 7    |
| Field Ration Mess                       | 7    |
| Officers' Mess                          | 7    |
| Wearing of the Uniform                  | 8    |
| Wearing of Fatigues                     | 8    |
| Wearing of Civilian Clothing            | 8    |
| Equipment and Supplies                  | 10   |
| Church Services                         | 12   |
| Stony Brook Air Force Station           | 12   |
| Westover Air Force Base                 | 12   |
| Catholic Services                       | 12   |
| Jewish Services                         | 12   |
| Protestant Services                     | 13   |

|  |    |
|--|----|
| Guide to Shops and Services            | 14 |
| Base Exchange                          | 14 |
| Cafeteria                              | 14 |
| Barber Shop                            | 14 |
| Theater                                | 14 |
| Mail Room                              | 14 |
| Recreation Room                        | 14 |
| Personnel Services Office              | 14 |
| Library                                | 15 |
| Cleaners                               | 15 |
| Map of Stony Brook Air Force Station   | 16 |
| Map of Otis Lake Campsite              | 18 |
| Map of Westover Air Force Base         | 20 |
| For Your Assistance                    | 22 |
| Dependents Assistance                  | 22 |
| Air Force Aid Society                  | 23 |
| American Red Cross                     | 23 |
| Legal Assistance                       | 23 |
| Dependent Personnel Medical Facilities | 24 |
| Sick Call                              | 24 |
| Pediatric Patients                     | 24 |
| Obstetrical Patients                   | 24 |
| Dental Care                            | 24 |
| General Information                    | 24 |
| Facilities at Westover Air Force Base  | 25 |
| Base Exchange                          | 25 |
| Exchange Office                        | 25 |
| Main Exchange                          | 25 |
| Service Station                        | 25 |
| Watch Repair Shop                      | 25 |
| Shoe Repair Shop                       | 26 |
| Main Cafeteria                         | 26 |
| TV Repair                              | 26 |
| Beauty Shop                            | 26 |
| Clothing Sales Store                   | 26 |
| MARS Station                           | 27 |
| Base Reenlistment                      | 27 |

|   | PAGE |
|---|------|
| Thrift Shop                               | 27   |
| Commissary                                | 27   |
| Banking Facilities                        | 27   |
| Theater                                   | 27   |
| Miscellaneous Information from Westover   | 28   |
| Library                                   | 28   |
| Base Newspaper                            | 26   |
| Post Office                               | 28   |
| Western Union                             | 28   |
| Westover Schools                          | 29   |
| Base Nursery School                       | 29   |
| Kindergarten                              | 29   |
| Grades One to Eight                       | 29   |
| High School                               | 30   |
| Day Nursery                               | 30   |
| Transportation                            | 31   |
| Airlines                                  | 31   |
| Base Bus                                  | 31   |
| Bus Lines                                 | 32   |
| Railroads                                 | 32   |
| Taxis                                     | 32   |
| Recreational Areas and Points of Interest | 33   |

HEADQUARTERS  
3084TH AVIATION DEPT GROUP (AHC)  
Stony Brook Air Force Station  
Chicopee Falls, Massachusetts

COMMANDER'S WELCOME

This booklet is designed to provide you with the information you need to become oriented with the way of life on Stony Brook and the many facilities available to you. In addition, general information regarding areas of interest in the Springfield area and the people of New England is included.

To our visitors, I feel confident, that you will find our personnel courteous and helpful. Do not hesitate to let us know how we can serve you.

To each new arrival, I extend my personal greeting, and I trust that this will be a profitable as well as a pleasant phase of your Air Force career.

We are proud of our station and the organizations to which we belong. I hope that you will in time feel the same way.

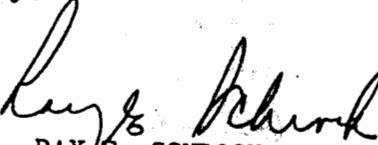
  
RAY E. SCHROCK  
Colonel, USAF  
Commander

GUIDE  
FOR  
NEWLY ASSIGNED PERSONNEL

The information contained in this pamphlet is to acquaint you with facilities available to you in this area. Attached to facility listings are sketches of Stony Brook Air Force Station and Westover Air Force Base. Important buildings or areas at Stony Brook Air Force Station can be identified by cross-referencing numbers shown on map with numbers on the listing.

Suggestions for improving this pamphlet are invited and should be submitted to the Group Director of Administrative Services.



GENERAL INFORMATION

Reporting In

All incoming personnel assigned to organizations of the 308th Aviation Depot Group will report to Pass and Badge Office, Station Clearance Section. Personnel will then report to building no. #103 for clearance instructions and forms. (See map page 16)

Identification

Wear your identification badge on your outer garment at all times while on this station. Take it off and keep it in a safe place while off the station. If your badge should become damaged, report to your orderly room immediately and take steps to get a new one. Report any loss of your badge immediately.

Automobile Registration

Register your private automobile immediately at the Pass and Badge Building at the main gate. Requirements are: valid state operator's license, minimum auto insurance coverage of \$5,000/\$10,000/\$5,000 public liability and property damage, valid vehicle inspection sticker and proof of ownership of the vehicle. Report any changes in registration, insurance or ownership immediately to Pass and Badge. If your vehicle decal becomes damaged or severely faded promptly get another and if you should sell or trade your car scrape off the decal and return the remnants to Pass and Badge.

## Camera and Private Firearm Registration

Privately owned firearms and cameras must be immediately registered at the Pass and Badge Building. Cameras may be retained in the dormitories, but firearms will be stored only in designated storage areas. Pictures may be taken in and of the administrative area only.

## Security

Security is a part of everyone's job on this station. Security is everyone's business. You are personally responsible for familiarizing yourself with, and adhering to, all security regulations which apply to you in the performance of your duties. Be security conscious on and off duty. Report any actual or suspected violations immediately to proper authority.

## Visits by Dependents and Guests

Dependents and guests of assigned military, AEC, and AEC Contractor personnel are authorized access to the administrative area. Dependents need only present their identification card at the gate. Guests must be accompanied by an assigned station member.

## Sick Call

Monday through Friday 0730-0800 hours at the dispensary building no. #103. After duty hours and Saturday and Sunday, for emergency only, all hours.

## HOUSING FACILITIES

### Bachelor Quarters

Officers - BOQ Building no. #102.

Technical and Master Sergeants - Upper floor Building no. #103.

Airmen, Lower five grades - Buildings nos. #104, #105, and #107.

### Family Housing

There is no provision made for family housing at Stony Brook, however, there is a limited amount of housing available at Westover Air Force Base for Stony Brook personnel. See your Squadron Commander for more information.

## STONY BROOK CLUB ACTIVITIES

### Officers' Club

Monday through Friday - 1630-1800

### NCO Open Mess

Monday through Thursday - 1200-2230  
Friday, Saturday and Paynight - 1200-2400

### Service Club

(Westover Only)

Programs of schedules are available at the club, building no. T-456, and are usually posted on bulletin boards. The club is open Monday through Friday from 1100 hours to 2300 hours and 1400 hours to 2300 hours Saturday and Sunday.



## DINING FACILITIES

### Field Ration Mess, Stony Brook Air Force Station

Breakfast - Monday thru Friday - 0600-0730  
Saturdays, Sundays & Holidays - 0600-0800

Dinner - Monday thru Friday - 1100-1230  
Saturdays, Sundays & Holidays - 1200-1300

Supper - Monday thru Friday - 1630-1800  
Saturdays, Sundays & Holidays - 1630-1730

Midnight Meal - Daily from 2330-0130 (Night Shift personnel only)

### Officers' Mess

Dinner - Daily 1130-1230

Breakfast and Supper may be eaten at Field Ration Mess.



### WEARING OF THE UNIFORM

The Air Force Uniform will be worn in the manner prescribed by AFM 35-10, and Stony Brook Air Force Station Regulation 35-6. The base commander will prescribe the optional period for wearing of both the winter and summer uniform, to coincide with the uniform regulations of Westover Air Force Base and our Wing. Notice of optional periods will be published in the daily bulletin and the Westover Yankee Flyer.

### Wearing of Fatigues

Personnel may wear fatigue clothing at all times within the confines of this Station when authorized by their supervisor. Wearing of the fatigue uniform while on Westover Air Force Base is limited to the following conditions:

- (1) By personnel engaged in work detail necessitating the wearing of the fatigue uniform.
- (2) By personnel residing on Westover Air Force Base when traveling from their quarters to this station.

### WEARING OF CIVILIAN CLOTHING

Personnel are authorized to wear civilian clothing while within the confines of this

station providing:

- (1) They are in an off-duty status.
- (2) They are not attending any type of formation.

Personnel are authorized to wear civilian clothing while traveling between this station and local suburban areas outside the military reservation. Items of military and civilian clothing will not be mixed.

## EQUIPMENT AND SUPPLIES

Whether you are arriving on temporary duty or for assignment to this installation, you may have business with Station Supply. It is located in Bldg #203, which is directly behind the fire station. The personnel are there to supply you with those items of government equipment necessary in the performance of your duties here on the station. All newly assigned personnel will clear through the Station Supply Division.

When you enter for your clearance, report to the rear-end (to the left) of Bldg #203. You will be asked for your AF Form 538 and your clearance form. You will be issued: 1 mattress cover, 2 sheets, 1 pillowcase, 2 blankets, 1 pillow, 1 pistol belt, 1 canteen, 1 canteen cover, 1 cup, 1 ammunition packet, 1 first aid pouch, 1 steel helmet, 1 liner, and 1 gas mask.

Your First Sergeant will later assign you to a dormitory room where the beds and mattresses are in place.

The unit supply representative will examine your AF Form 538 (Personnel clothing and Equipment Record) and assure that all authorized retention type items are on hand. If your 538 does not show possession of the authorized items, action will be initiated at this time to procure the necessary equipment. If the items were previously issued and are not now in your possession, the unit supply representative is instructed to issue these items and accomplish a statement of charges or schedule of collection.

If you report to this station between September and March, you will obtain winter clothing consisting of an N3A blue jacket and one pair of over-shoes, if you are an Air Police or Officer.

Personnel other than those listed above, will receive an O.D. parka in lieu of the N3A jacket.

Station Supply maintains on hand sufficient mess kits, knives, forks and spoons for the needs of the entire organization, if and when required. Your weapon will be issued to you by your section or Division supervisor after you reach your duty station.



The items of equipment issued to you remain government property and you are responsible and can be held liable for replacement for any of these items if they are lost or damaged through your negligence. Take care of the equipment, use it in the prescribed way, make periodic checks on its condition and if it becomes unserviceable, return it to supply and the item will be replaced. Although Station Supply is operated by the Support Squadron, it is your unit supply. The better you care for your equipment, the less it will cost us to operate the station.



## CHURCH SERVICES

### Stony Brook Air Force Station

There are no services held at Stony Brook Air Force Station; however, Stony Brook Personnel are welcome and encouraged to attend any of the following services at Westover Air Force Base.

### Westover Air Force Base

#### Catholic Services

- Sunday - Masses at 0800, 0900, 1000, 1100 and 1200, Chapel One, Confessions before and during first two masses. Baptisms at 1100.
- Daily - Mass at 1200, Chapel One
- Monday - 1930 Holy Name Society, Religious Center first Monday of the month.
- Wednesday - 1930 Ladies Sodality, Religious Center every second Wednesday of the month.
- Saturday - 0900 Catechism class for children, Westover School  
1600-1800 Confessions, Chapel One.

Confessions are also held every day before the noon mass.

#### Jewish Services

- Thursday - 1900 Service, Religious Center

### Protestant Services

- Sunday - 0830 Lutheran Service, Chapel Two  
0930 General Worship, Chapel Two  
0930 Sunday School (All classes held in Westover School, Bldg T-524)  
1100 General Worship, Chapel Two  
1830 Youth Fellowship for Teenage Boys and Girls, Religious Center  
1930 "Country Church" Chapel Two
- Tuesday - 1900 Christian Science Service, Chapel Two
- Wednesday - 1330 Woman's Chapel Guild, Religious Center, second Thursday of each month  
1930 Mid-week Service
- Thursday - 1900 Chapel Choir, Chapel Two

GUIDE TO SHOPS AND SERVICES

Stony Brook Air Force Station

Stony Brook Air Force Station has complete and compact facilities for Shops and Services, located in the basement of building no. #108. Included in these facilities are the Base Exchange, Cafeteria, Barbershop, Theater, Mail Room, Recreation Room, Personnel Services Office, Library and Cleaners. Hours of operation are as follows:

Base Exchange: Monday thru Friday - 0930-1730

Cafeteria: Monday thru Friday - 0630-1930  
Saturday, Sunday & Holidays 0900-1930

Barber Shop: Monday thru Friday -1000-1800

Theater: Monday, Wednesday & Thursday - 1615-2015

Mail Room: Combination boxes are available for all personnel and mail can be picked up at the window during the following hours only: Monday thru Friday 1130-1215 and 1615-1645.

Recreation Room: Daily from 1030 hours

Personnel Services Office: Personnel Services Supplies can be withdrawn only from 0730 to 1100 hours Monday through Friday. Picnic area is on a first come first served basis. A full sports program, including soft ball, bowling and golf is available. Inquire at Personnel Services or watch the Daily Bulletin for information on teams, etc. Also under the direction of Personnel Services are the

woodworking shop, building no. #103, and the photo lab, building no. #107, which are available by appointment.

Library: Monday through Friday 0930-1930.

Cleaners: Monday through Friday 0830-1700. Dry cleaning requires three days. Laundry four days.

LISTING  
For  
Westover Air Force Base

1. Visitor Control Office
2. Identification & Registration
3. Service Club
4. Base Thrift Shop
5. Dependents' Assistance
6. NCO Open Mess
7. Base Hospital
8. Officers' Open Mess
9. Base Post Office
10. Base Theater
11. Base Legal Office
12. Base Finance
13. American Red Cross
14. Base Cafeteria
15. Shoe Repair Shop
16. Base Library
17. Base Bank
18. Base Exchange
19. Base Barber Shop
20. Cleaners/TV Repair
21. Billeting Office/Western Union
22. Catholic Chapel
23. Protestant/Jewish Chapel
24. Base Dental Clinic
25. Transient Family Quarters
26. Same
27. WAF Orderly Room
28. Hangar 1
29. BX Gas Station
30. Commissary
31. Base Gymnasium
32. Western Union
33. Laundromat
34. Base Operations

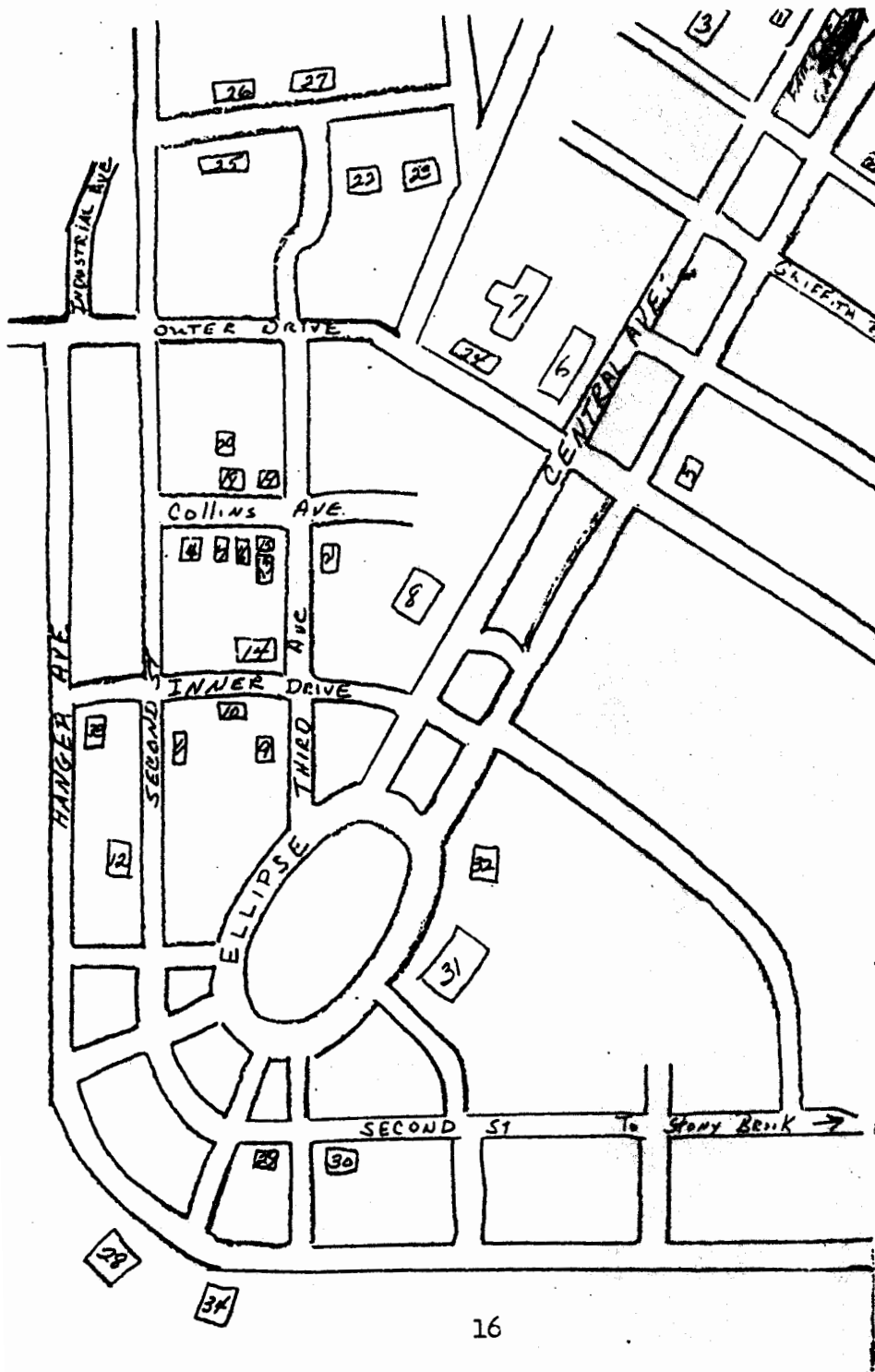

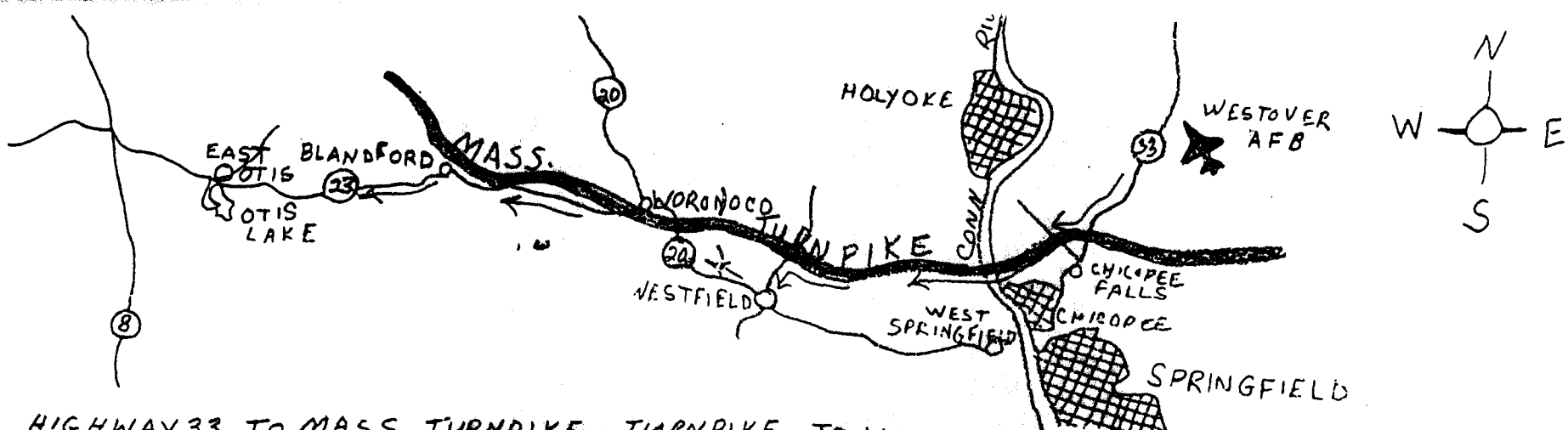

HIGHWAY 33 TO MASS. TURNPIKE, TURNPIKE TO WESTFIELD, HIGHWAY 20;  
 HIGHWAY 20 TO WORONOCO, HIGHWAY 23; HIGHWAY 23 TO EAST OTIS.

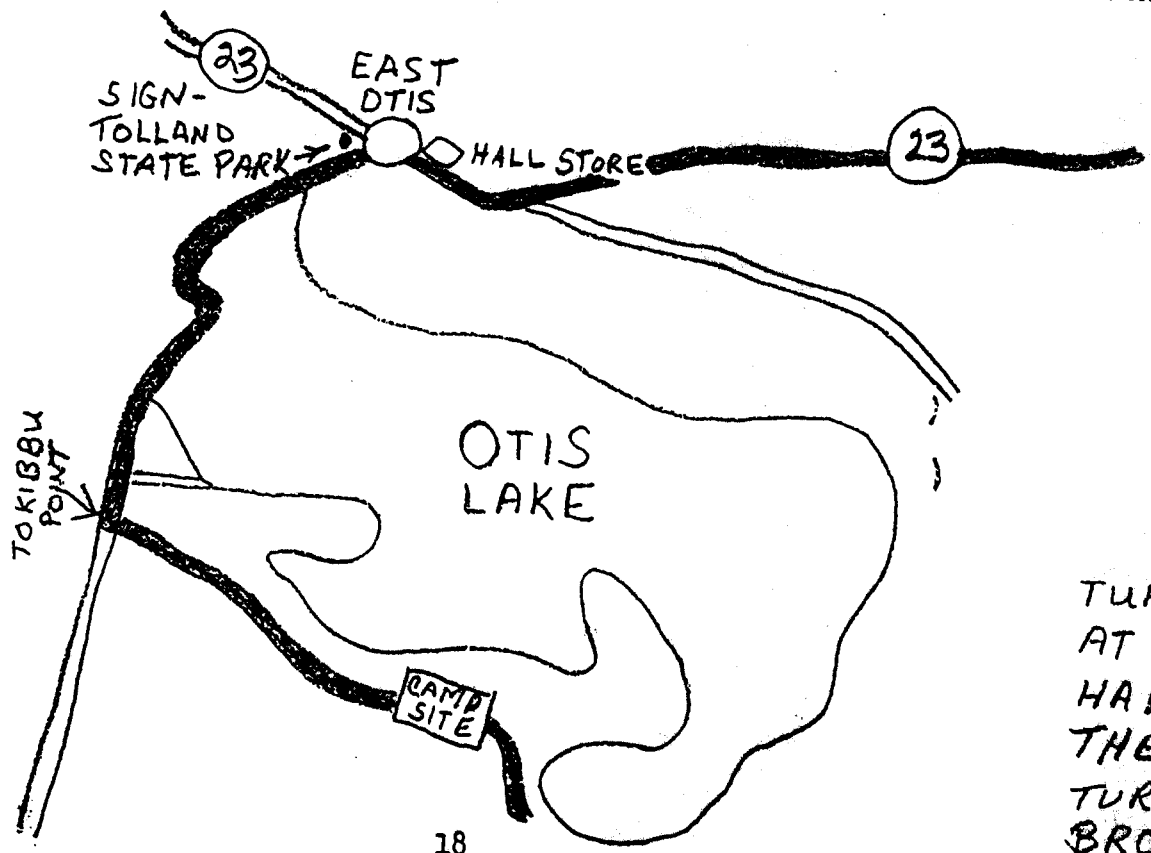

ROUTE TO  
 OTIS LAKE  
 CAMP SITE

TURN LEFT OFF HIGHWAY 23  
 AT EAST OTIS OPPOSITE THE  
 HALL STORE AND PROCEED TO  
 THE ROAD MARKED 'TOKIBBU POINT'  
 TURN LEFT AND FOLLOW TO STONY  
 BROOK CAMP SITE.

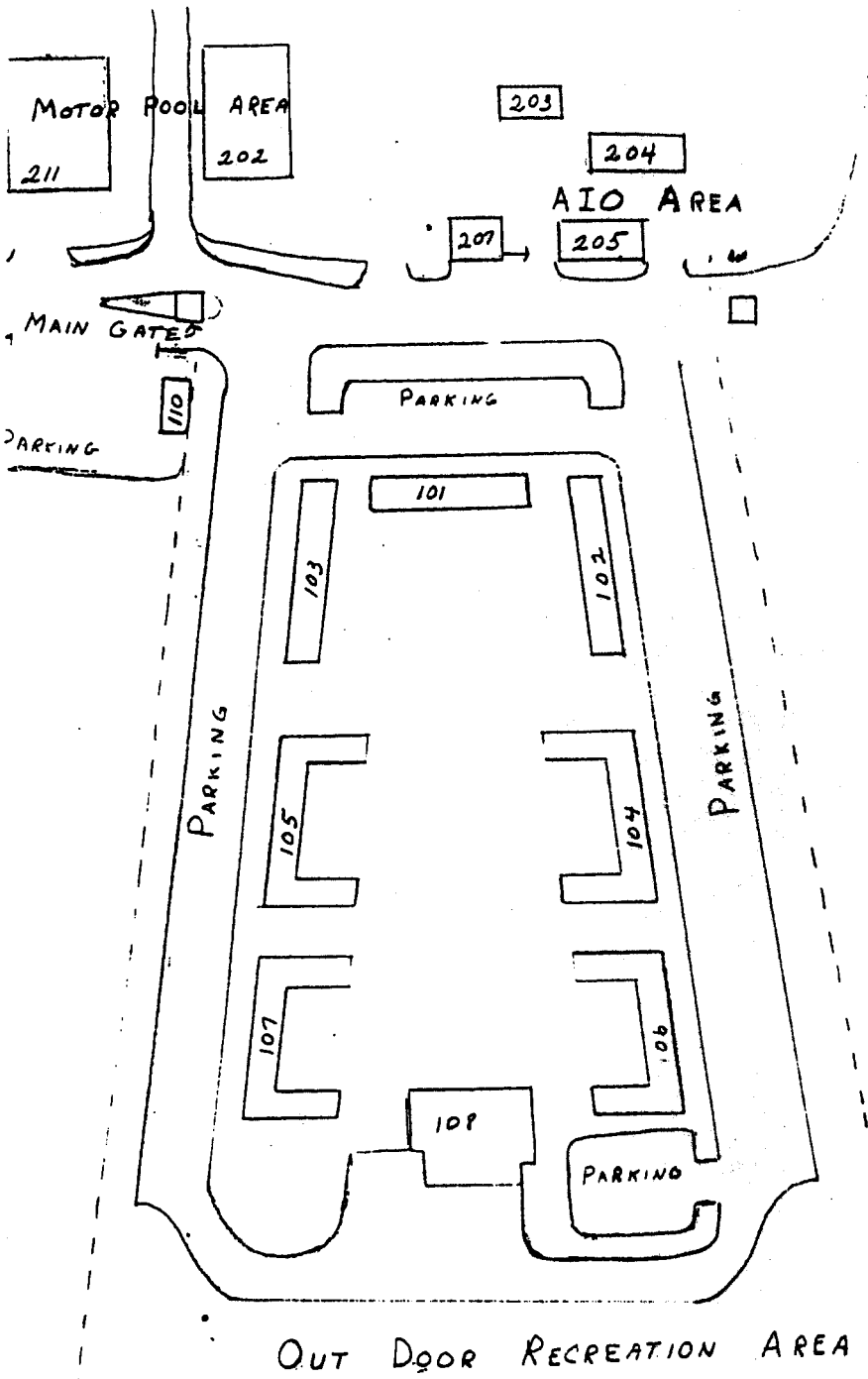

ALPHABETICAL LISTING  
Stony Brook Air Force Station

- Administrative Services - Bldg 101
- Airmen's Records - Bldg 103
- Barber Shop - Bldg 108
- Barracks - Hq Sq Sec - Bldg 105
- 3084th A P Sq - Bldg 106
- 3084th Sup Sq - Bldg 107
- 3097th A D Sq - Bldg 105
- Base Exchange - Bldg 108
- Classification Office - Bldg 103
- Commander - Hq Sq Sec - Bldg 103
- 3084th A P Sq - Bldg 101
- 3084th Sup Sq - Bldg 101
- 3097th A D Sq - Bldg 101
- Dentist - Bldg 103
- Dining Hall - Bldg 108
- Dispensary - Bldg 103
- Drivers Training - Bldg 103
- Dry Cleaners - Bldg 108
- Education Office - Bldg 103
- Finance Office - Bldg 103
- Ground Safety Office - Bldg 103
- Hobby Shop (Woodworking) - Bldg 103
- Laundry - Bldg 108
- Library Bldg 108
- Mail Room - Bldg 108
- NCO Open Mess - Bldg 103
- Officers' Open Mess - Bldg 102
- Officer's Quarters - Bldg 102
- Personnel Services - Bldg 108
- Recreation Hall - Bldg 108
- Snack Bar - Bldg 108
- Special Services Supply - Bldg 107
- Theater - Bldg 103
- Training Office Bldg 103
- Transient Quarters - Bldg 106

## FOR YOUR ASSISTANCE

The following assistance agencies are located at Westover Air Force Base, however, they are set up for Story Brook personnel as well as Westover personnel.

Dependent's Assistance: The Dependent's Assistance Program is set up to relieve emergencies and undue hardship of Air Force families, especially when first reporting in to a new base or during the absence of the military member of the family.

Volunteer workers act as liaison agents in finding off-base housing and maintaining a current file of listings. Newcomers to the base may also borrow dishes, linens, bedding and beds while awaiting the arrival of household goods. Emergency baby-sitting service, transportation and shopping services are also available.

Westover's Dependent's Assistance Center is located in Bldg. T-279, across the street from the Westover NCO Open Mess. Hours of operation are from 0800 to 1700 Monday through Friday.

Among other services the DAF provides either directly or indirectly are: medical and financial aid, personal and home services; allotment assistance, casualty assistance, liaison with other on-base military facilities and liaison with community agencies such as the Red Cross.

The DAF attains its greatest importance during time of overseas deployment by SAC airmen. On such occasions, workers of the center personally contact airmen's wives to acquaint them with the center's facilities and ease any problems.

Designed to aid those in distress, the DAF can supply aid in any emergency within minutes after receipt of a request.

Air Force Aid Society: An emergency relief organization serving members of the Air Force and their dependents. When emergencies arise, AFAS provides financial aid in the form of non-interest bearing loans or grants. The local AFAS chapter is located in Bldg T-239.

American Red Cross: The Westover field director of the ARC is located in Bldg T-121. In general, the ARC will provide counseling service, direct communication through ARC channels and financial assistance in cases of emergency. ARC can also be called upon to assist in expediting emergency leave and extension of leave due to emergency cases.

The ARC office is open 0800 to 1700 hours daily 0800 to 1200 hours Saturday. During off duty hours and Sunday, the base telephone operator can contact the ARC person on stand-by duty.

Legal Assistance: The Staff Judge Advocate's Office is located in Bldg. T-104, next to the base theater. Legal assistance may be obtained on domestic matters, personal injury and property damage, insurance, contracts, leases, debts, wills, and difficult tax problems between the hours of 1330-1500 Monday thru Thursday. Notarial services are also available during the same hours.

DEPENDENT PERSONNEL MEDICAL FACILITIES  
Westover Air Force Base

Sick Call: Dependents beyond pediatric age and not involving obstetric care should call the Dependents Outpatient Clinic, Ext 20-349, for an appointment. Dependents will be seen BY APPOINTMENT ONLY. Non-life emergencies will be seen at any hour at the Out-Patient Clinic.

Pediatric Patients: Children of military personnel through age 12 are seen by appointment only, Monday through Friday. Appointment may be made by phoning 20-346.

Obstetrical Patients: Care is limited to 60 patients monthly on a first come first served basis. Others may apply to civilian facilities and doctors under the Medicare Bill.

Dental Care: Dental care is limited to emergencies only.

General Information

Emergency Ambulance Service: At any hour, Phone 20350 or IX 3-3233 from off base.

Medical Specialty Clinics: Cases requiring specialized care will normally be referred by the physician from one of the previously indicated medical calls. If in doubt as to procedure, phone 20-263.

FACILITIES AT WESTOVER AIR FORCE BASE

Base Exchange

Exchange Office: All executive business is transacted in Bldg. T-49, adjacent to the main exchange store. Checks may also be cashed here by military personnel. A \$50 minimum is placed on personal checks. Hours of operation are from 0745-1645 Monday through Friday.

Main Exchange: Stocked with a large assortment of merchandise such as household goods, clothing, cameras, luggage, toilet articles, etc., the main exchange store is located in Bldg. T-136, across the street from the base library. Hours of operation are from 0900-1800 Monday through Thursday, 1000-2100 Friday and 0900-1430 Saturday.

Service Station: In addition to gas and oil, the service station sells tires, tubes, batteries and small accessories, washes and lubricates cars, and makes minor repairs. The station is located off the main rotary near Hangar One. Hours of operation are from 0700-2100 Monday through Friday 0700-2100 Friday and 0700-1430 Saturday and Sunday 0900-1500.

Watch Repair Shop: Operated by two expert repairmen, the watch repair shop specializes in all types of watch, clock and jewelry repairs. It is located in Bldg. T-49, in front of the exchange office. Hours of operation are from 0900-1645 Monday through Friday. If you can't get to Westover, you can leave articles to be repaired at the Stony Brook Exchange.

Shoe Repair Shop: All types of shoe repairs are available. The shop is open from 0800-1730 Monday through Friday and 0800-1200 Saturday and is located in Bldg. T-116, next to the base library. You can leave shoes to be repaired at the Stony Brook Base Exchange.

Main Cafeteria: The cafeteria, located in Bldg. T-120, near the base theater, serves delicious meals and tasty snacks. Hours of operation are 0900-1900 Monday through Friday and 0900-1400 Saturday.

TV Repair: A television repair shop, located in the rear of Bldg. T-137, provides services obtainable by calling Ext 2444. Hours of operation are from 0900-1800 Monday through Friday and 0900-1430 Saturday.

Beauty Shop: The Base Exchange Beauty Shop, located in Bldg. T-124, is open from 0900-1800 hours Monday through Friday and 0900-1430 hours on Saturday.

The Beauty Shop also provides a spot reducer and exerciser for its patrons. The figure conditioning aid is designated to relieve muscular tensions as well as assist in weight control and figure measurements. An attendant, trained in this world-famous "Aid to Beauty" system, is on duty at all times.

Clothing Sales Store:

Located at the intersection of Anderson Rd and Pendleton Ave., the Westover Clothing Sales Store is well stocked with the uniform requirements of officers, airmen and WAF personnel. A tailor and seamstress are employed.

MARS Station: A Military Affiliates Radio System (MARS) station is maintained on Westover by trained personnel completing the unofficial duties in their spare time. Messages from and for Westover personnel are transmitted to other MARS stations the world over.

Base Reenlistment: Open from 0800-1700 Monday thru Friday and 0800-1200 Saturday, the Base Reenlistment Section is located in Bldg. T-239, Westover.

Thrift Shop: Personnel wishing to sell articles may utilize the Thrift Shop, located in Bldg. T-108, in front of the Westover Base Bank. The shop is open from 0930-1230 Monday through Friday. Phone 5142. The seller sets the price on the articles to be sold and the Thrift Shop adds 10 per cent for service charge.

Commissary: A large assortment of canned goods, fresh vegetables and meat is available at the Base Commissary located in Bldg. T-502. Hours of operation are from 1000-1800 Monday through Thursday and 1300-2100 Friday, and 1000-1400 Saturday. All military personnel and dependents must present identification cards to purchase foodstuffs.

Banking Facilities: A local branch of the Hadley Falls Trust Co., is located adjacent to the Westover library in the main base exchange parking area. Hours of operation are 0900-1500 hours daily except Saturday and Sunday.

Theater (Westover): The Westover theater is located just off the main rotary near the junction of Third Ave. and Inner Drive. The proper uniform for admission to the theater is Class "A" military. Programs are scheduled for 1800 and 2015 hours each evening with matinees at 1415 on Saturdays, Sundays and holidays.



MISCELLANEOUS INFORMATION

From

WESTOVER AIR FORCE BASE

Library: The Westover library offers a large selection of fiction, non-fiction, periodicals, and newspaper reading materials. Also available is a music room with headphones and phonograph. The library, Bldg T-115, is located in the parking lot across from the main base exchange. The library is open weekdays from 0800 to 2100 hours, weekends, 11:00 to 2100 hours.

Base Newspaper: The "YANKEE FLYER" is the unofficial Westover newspaper. Deadline for news copy is 1700 hours Wednesday and photo deadline is 1200 hours Wednesday. The paper is distributed each Friday morning at Westover. The newspaper office is located in Bldg T-121. Phone 2-3209. Papers are received at Stony Brook on Friday afternoons.

Post Office: A branch of the Chicopee Falls Post Office is located at Westover near base headquarters. Money order and registry window is open 0830 to 1630 hours weekdays. The stamp window is open 0815 to 1645 hours weekdays. No hours Saturdays, Sundays or holidays.

Western Union: Telegraphic service of the Western Union is available in the billeting office, Westover, on Third Ave., Bldg T-159. Hours of operation are 0800 to 1700 hours weekdays. Telephone connection after office hours, call Westover Ext. 6110.

WESTOVER SCHOOLS

Base Nursery School: Designed for children of ages three and four, the Base Nursery School is a non-profit organization operated for children of all personnel. Hours of operation are 0900 to 1130 on weekdays. The charge is \$1.5 per month. Four trained teachers are on hand to take charge of a maximum of 50 children. The school is located in Bldg T-437. Instruction offered includes games, basic art work, and visual instruction.

Kindergarten: The base kindergarten is part of the Westover School system and is located in the main school, Bldg F-524, just off Central Ave. near the Fairview Gate. It is available for children who are four years and nine months on or before Sept 1.

Grades One to Eight: The Westover School, operated under the Chicopee, Mass., school system conducts classes in Kindergarten and grades one thru eight. New personnel at Westover may register their children at the school office Monday through Friday, 0830 to 1600 hours. Bottled milk is available on a weekly basis and hot lunches are served in the school cafeteria at a nominal charge. Pamphlets and further information regarding the Westover Schools are available at the school or can be had by writing or phoning school officials.

One school has a shop, home economics, and general science rooms, all fully equipped. Also included in the school is a spacious 59 by 79 feet and 20 feet high gymnasium with folding stage and sports equipment for basketball.

High School: Children of high school age may enroll in one of the many local high schools. All of the area high schools are of the highest calibre and each is a qualified prerequisite for higher education.

The central office of the Springfield school system is located at 32 Spring St., telephone RE-public 3-2132, of the Chicopee school system at 135 Grape St., telephone LYceum 4-4711, and of Holyoke at 98 Suffolk St., telephone JEFFerson 4-5678.

It will be necessary for you to have immunization records, transfer cards and report cards for your children when you move to this area.

Day Nursery: Qualified civilian and dependent personnel operate a nursery for the convenience of all personnel and their dependents residing on and off base. The nursery is located in building T-272 near the Fairview gate.

The nursery is open weekdays from 0730 to 2330 hours; Saturdays from 0900 to 0130 hours; Sundays from 0815 to 2380 hours.

A nominal charge is made for the care of children. Hourly rates for one child are 35 cents, two children 45 cents, and three children 50 cents. Hot lunches and suppers are available at 35 cents per meal.

The nursery offers a baby feeding service for 25 cents if parents supply the food.

Special working and hospital rates for a nine hour, five-day week are also available.

## TRANSPORTATION

Airlines: Bradley Field, located in Windsor Locks, Conn. is the major commercial airport serving the Springfield area. The major airlines are American Airlines, Inc., phone ST 8-4571; Eastern Air Lines, Inc., phone ST 8-0991; Mohawk Airlines, Inc., at Barnes Field, Westfield, Mass., phone RE 7-0107; Slick Airlines, Inc., ask operator for Enterprise 1580; Transocean Air Lines, phone NA 3-4475 and United Air Lines, phone RE 9-3851.



Base Bus (Westover Only): The base bus operates between P650 and the NCO Open Mess providing service every 30 minutes from 0600-1800 weekdays and from 0600-1300 Saturdays.

Starting at P650 the route follows Industrial Rd. east to Outer Drive; right on Outer Drive to Hangar Ave. past Hangar One to Inner Drive; left on Inner Drive to Third Ave.; right on Third Ave. to Outer Drive; right on Outer Drive, left on Johnson and right on Beesley Drive past Eighth Air Force Area and the base hospital to the NCO Open Mess parking lot, where the bus turns and goes back over Beesley and Johnson, then west on Anderson Road back to P650.

Bus Lines: There are four major bus lines serving the Springfield area. The Greyhound Bus Depot is located at 50 Worthington St. Springfield, and information on the schedules may be obtained at RE 6-8831.

The Interstate Bus Corp. operates their scheduled bus runs through upper New York State, and the New England area. The Interstate Bus Terminal is located at 137 Bridge St. Springfield, and information may be obtained at RE 9-3826.

Direct connections for Boston and other New England areas is scheduled at the Peter Pan Bus Line located at 144 Bridge St., Springfield. Information and reservations may be obtained at RE 2-3173.

Busses to New York, Washington and points south and Lowell, Hampton Beach, Portland and points north are available at the Trailways Bus System located at 137 Bridge St., Springfield. The phone number is RE 9-3826.

Railroads: There are three railroad companies serving the Springfield area. They are the Boston & Albany Railroad; the Boston & Maine Railroad and the New Haven Railroad, all of which are located at the Union Station in Springfield. Information and reservations may be obtained for the three railroads at RE 4-7341.

Taxis: The ABC Taxi Company serves Westover Air Force Base and Stony Brook Air Force Station. A one way trip anywhere on Westover is 25¢. The fare to Stony Brook from Westover is 50¢. Phone LY 4-6688 for service. Taxis other than the ABC taxi will discharge their passengers coming into Westover at the base gates.

## RECREATIONAL AREAS And POINTS OF INTEREST

Stony Brook is about 100 miles equi-distant from Boston on the east, New York on the south and Albany on the west. This brings big league baseball, college football, professional football, boxing, hockey, professional basketball, college basketball and other sports within easy driving distance.

Ocean swimming, fishing and yachting are within easy distance with Long Island Sound to the south and the Atlantic Ocean to the east.

Local amusements, sports and entertainment:

All individual tastes can be satisfied locally. The Springfield and Holyoke area has streams, lakes, and reservoirs that are available for boating, fishing and swimming.

Amusement parks, picnic areas and state park reserves are within a half hour drive in any direction making this area a paradise for picnicking, hiking, and mountain climbing.

In the Holyoke-Springfield areas are several colleges which make college sports available and Springfield being a member of Eastern Baseball League brings good minor league ball to the local residents.

Bowling, theaters, dancing and museums are accessible to all personnel seeking entertainment.

Several areas of interest are listed below:

Mountain Park - Holyoke  
Look Park - Northhampton  
Riverside Park - Agawam  
Hockey - Springfield Coliseum  
Mount Tom Park - Holyoke  
Springfield Museum - Springfield  
Skinner State Reservation - Mt Holyoke  
Skinner Museum - South Hadley  
Hampton Ponds - Route 303 between Holy-  
oke and Westfield  
Forest Park - Springfield  
Quabbin Reservoir - Thirty miles north-  
west of Springfield on Route 202  
Holy Cross University - Worcester  
AIC and Springfield Colleges - Spring-  
field